

Gearbox
WVSA / WVSFA

Down Angle by REINTJES

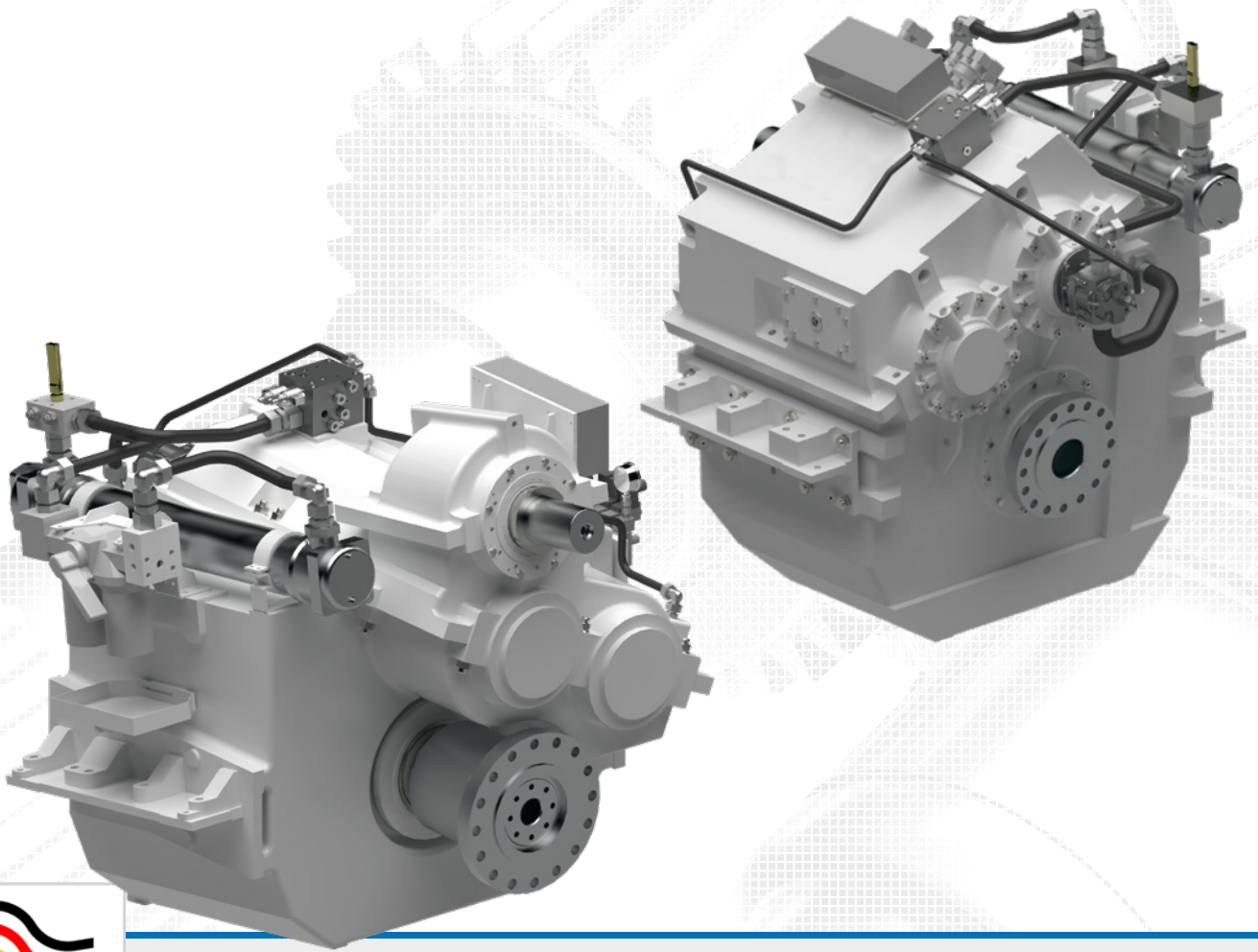

Gearbox

WWSA / WWSFA

■ WWSA

Wendeuntersetzungsgetriebe Achs**V**ersetzt für **S**chnelle Schiffe in Down-**A**ngle-Ausführung mit Beveloid-Radstufe (reverse reduction gearbox shafts offset for fast vessels in down angle design with beveloid gear step)

■ WWSFA

Wendeuntersetzungsgetriebe Achs**V**ersetzt für **S**chnelle Schiffe in Down-**A**ngle-Ausführung mit Beveloid-Radstufe als U-Trieb (reverse reduction gearbox shafts offset for fast vessels in down angle design with beveloid gear step as U-drive)

■ ZWWSFA xxx U

Zweigang-**W**endeuntersetzungsgetriebe Achs**V**ersetzt für **S**chnelle Schiffe in Down-**A**ngle-Ausführung mit Beveloid-Radstufe als **U**-Trieb (two-speed reverse reduction gearbox shafts offset for fast vessels with an attached beveloid gear step in down angle design as U-drive)

Customer Benefits

- Optimal low noise gear design
- Wide range of available reduction ratios in fine increments
- Light and robust design for demanding operating profiles and applications
- Split design housing for ease of on-site maintenance
- Hybrid options available
- Compact vertical design
- Optimal center distance to match propulsion train

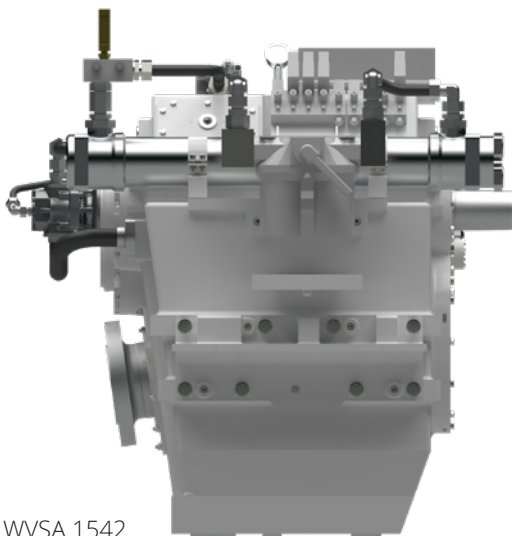

WWSA 1542

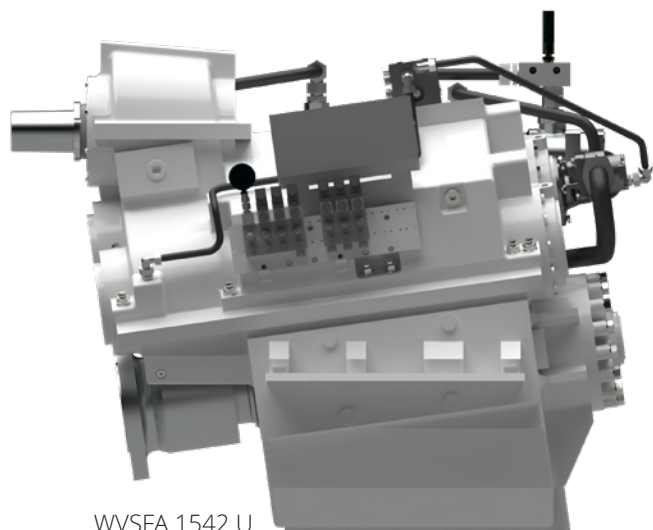

WWSFA 1542 U

**Standard
Scope of supply**

- Aluminium housing
- Beveloid toothed spur gears, case hardened
- Built-in hydraulically operated REINTJES disc clutches with steel/sintered friction surface
- Built-in propeller thrust bearing
- Electric control valve/GBX-C:
 - Smooth engagement by optimised pressure build-up
- Full power transmission in both directions of rotation
- Integrated oil sump with common circuit for operating pressure and cooling
 - Oil pump and oil filter accessible from outside
- Integrated, seawater resistant oil cooler for cooling water inlet temperature up to 32 °C
- Input free end with 1:30 taper
- Forged-on output flange
- Paint finish with synthetic resin varnish in RAL 7001 colour silver grey
- Reduction ratios: up to 16 different ratios available
- Free standing (no SAE housing)
- Rigid foundation with bolted mounting feet
- Supervision acc. to REINTJES standard with double filter

Available options

- Auxiliary drives:
 - PTO, non-controllable K21A, K31B
 - PTI/PTO (Hybrid drives), non-controllable K21B, K31B
 - PTI/PTO (Hybrid drives), controllable execution (K35B) with optional holding device for e-motor
- Flexible coupling
- Electric stand-by pump (supplied separately)
- Output counter flange
- Oil cooler 38 °C water inlet temperature
- Electric control valve GBX-A
 - Comfort clutch with easy adjustable engagement times according to customer requirement
 - Trolling function (ADS)
- Resilient mounting
- Screw-on mounting
- Two-speed option for WVSFA (ZWVSA xxx U) available for sizes 442, 742 & 942

Class acceptance

- Type approval (LRS, RINA, BV, CR)
- Drawing approval
- Full class according to classification society incl. supervision

Space saving design

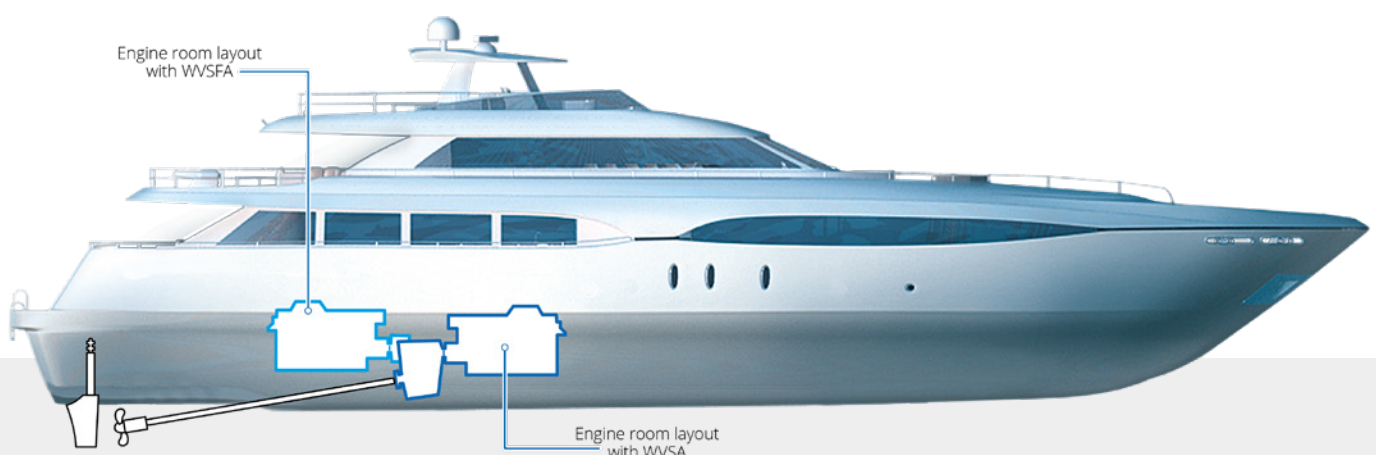

Specifications

WVSA



Name	WVSA 1542	WVSA 1942
Input Speed	1600 - 2300 rpm	1600 - 2300 rpm
P/n	up to 1.55 kW/rpm	up to 2.04 kW/rpm
Input Power	1400 - 3500 kW	1800 - 4900 kW

Weight & Dimensions

L1	142 mm	154 mm
L2	909.4 mm	997 mm
L6	1200 mm	1400 mm
B1	650 mm	650 mm
B2	1380 mm	1420 mm
H1	860 mm	960 mm
H2	457.9 mm	500 mm
H3	600 mm	640 mm
H4	370 mm	415 mm
D1	106.9 mm	116.9 mm
D2	330 mm	330 mm
α (alpha)	8°	8°

Weight (dry)	1700 kg	2050 kg
Oil	140 l	170 l

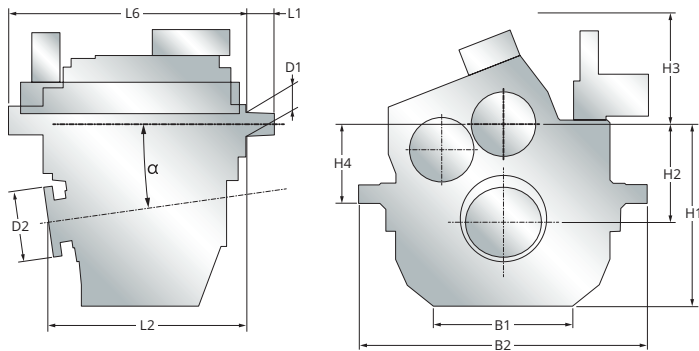

Engine Power

kW	1400	1600	1800	2000	2200	2400	2600	2800	3000	3200	3400	3600	3800	4000	4200	4400	4600	4800
BHP	1877	2146	2414	2682	2950	3218	3487	3755	4023	4291	4559	4828	5096	5364	5632	5900	6169	6437

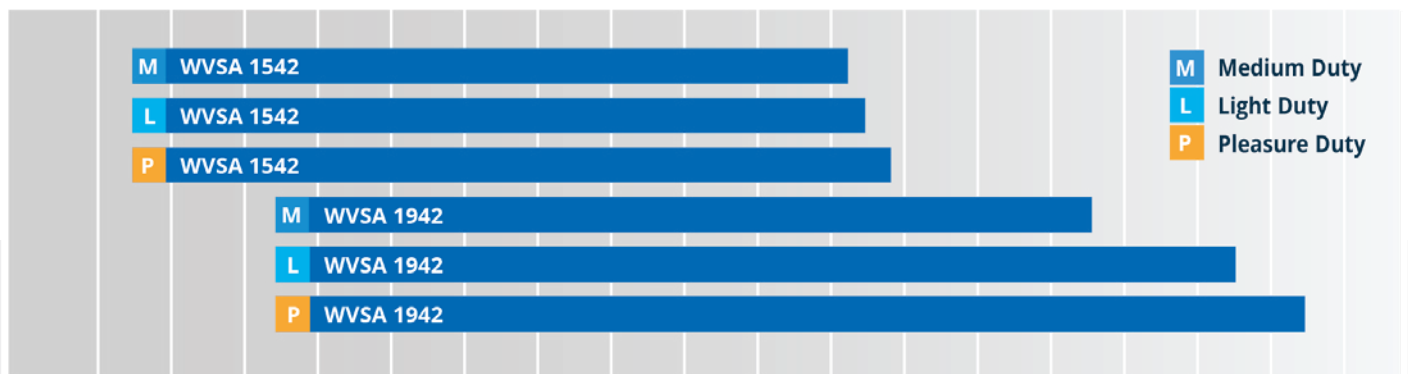

Noise reduced REINTJES beveloid tothing

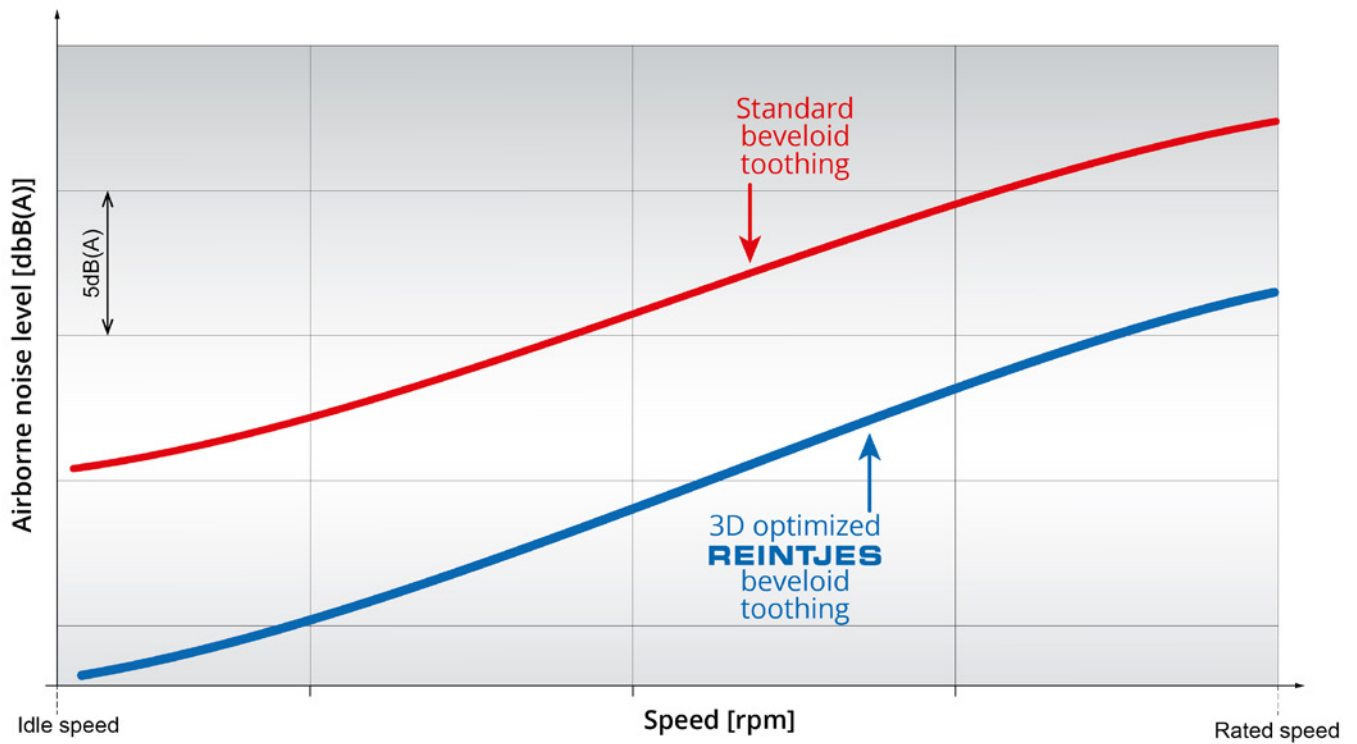

© REINTJES GmbH

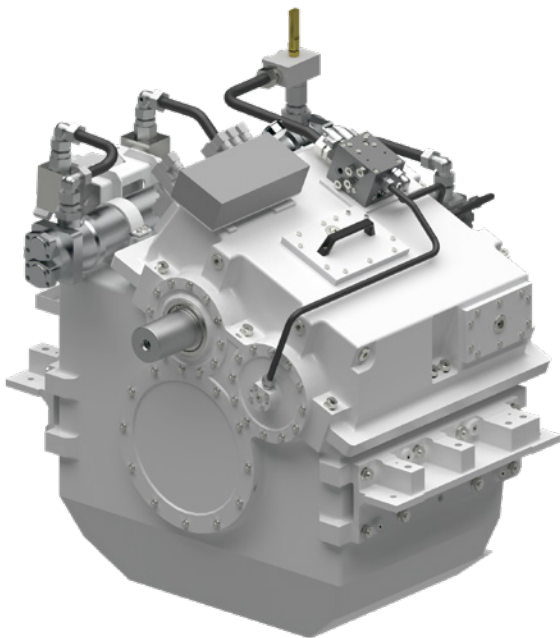

WSA 1542, engine side

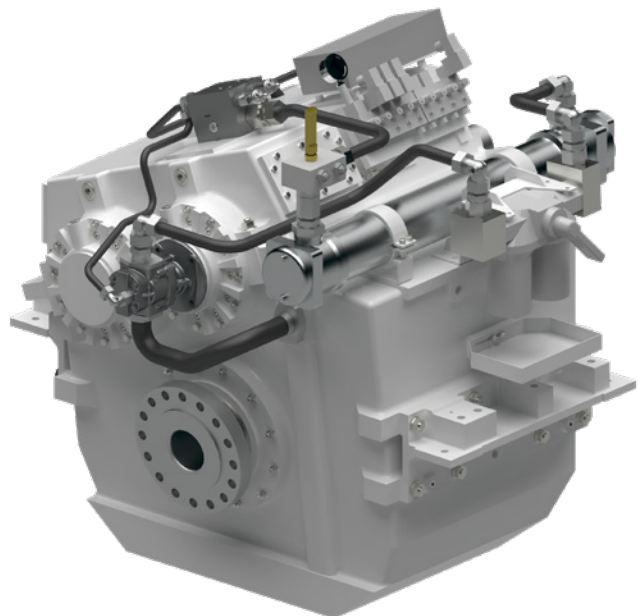

WSA 1542, propeller side

Specifications

WVSFA

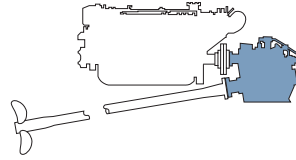

Name	WVSFA 442 U	WVSFA 742 U	WVSFA 942 U	WVSFA 1542 U	WVSFA 1942 U
Input Speed	1600 - 2500 rpm	1600 - 2350 rpm	1600 - 2350 rpm	1600 - 2200 rpm	1600 - 2150 rpm
P/n	up to 0.645 kW/rpm	up to 0.932 kW/rpm	up to 1.299 kW/rpm	up to 1.665 kW/rpm	up to 2.048 kW/rpm
Input Power	700 - 1400 kW	1100 - 2300 kW	1400 - 3000 kW	2100 - 3400 kW	2300 - 3800 kW

Weight & Dimensions

L1	97 mm	107 mm	117 mm	142 mm	154 mm
L2	64.7 mm	103 mm	132 mm	142.3 mm	141.7 mm
L6	1190 mm	1330 mm	1420 mm	1530 mm	1630 mm
B1	540 mm	560 mm	560 mm	600 mm	650 mm
B2	1090 mm	1130 mm	1170 mm	1360 mm	1360 mm
H1	880 mm	810 mm	890 mm	1010 mm	1100 mm
H2	556.6 mm	566.7 mm	628.8 mm	697.4 mm	726 mm
H3	470 mm	390 mm	425 mm	490 mm	400 mm
H4	425.2 mm	510 mm	585 mm	630 mm	700 mm
D1	74.9 mm	91.9 mm	101.9 mm	106.9 mm	116.9 mm
D2	280 mm	300 mm	300 mm	375 mm	375 mm
α (alpha)	10°	8°	8°	8°	8°

Weight (dry)	900 kg	1100 kg	1350 kg	2100 kg	2400 kg
Oil	60 l	88 l	98 l	135 l	190 l

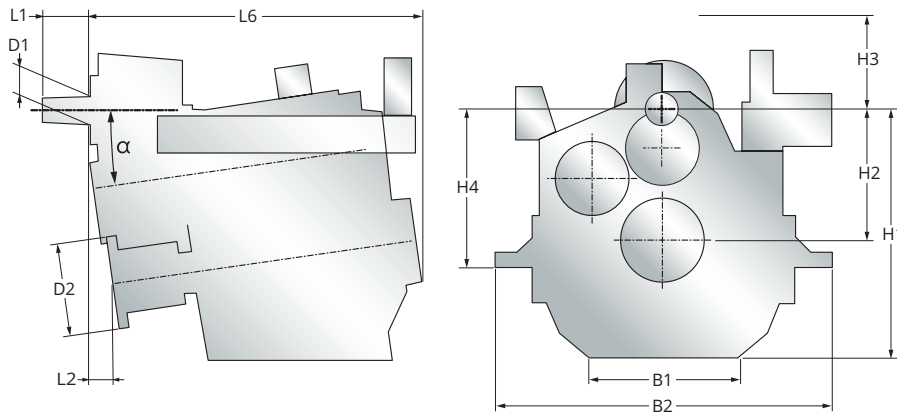

Engine Power

kW	600	900	1200	1500	1800	2100	2400	2700	3000	3300	3600	3900	4200
BHP	805	1207	1609	2012	2414	2816	3218	3621	4023	4425	4828	5230	5632

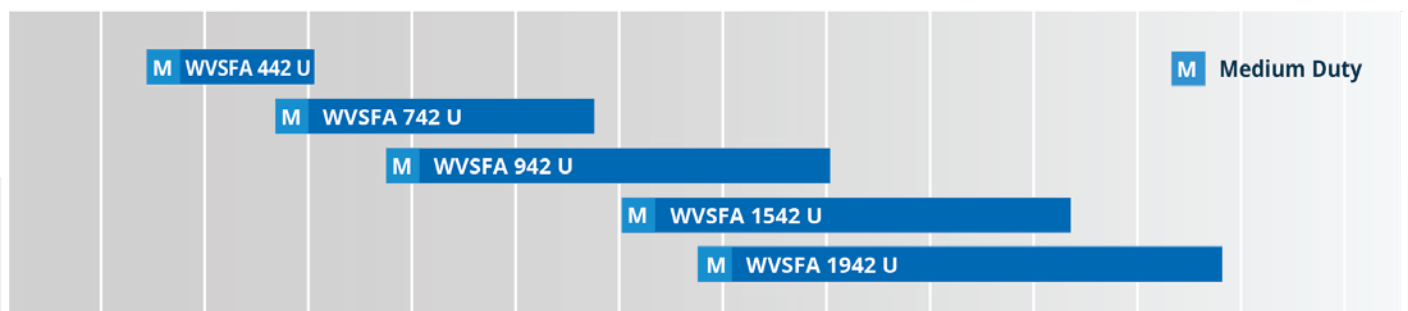

Connection to engine without cardan shaft

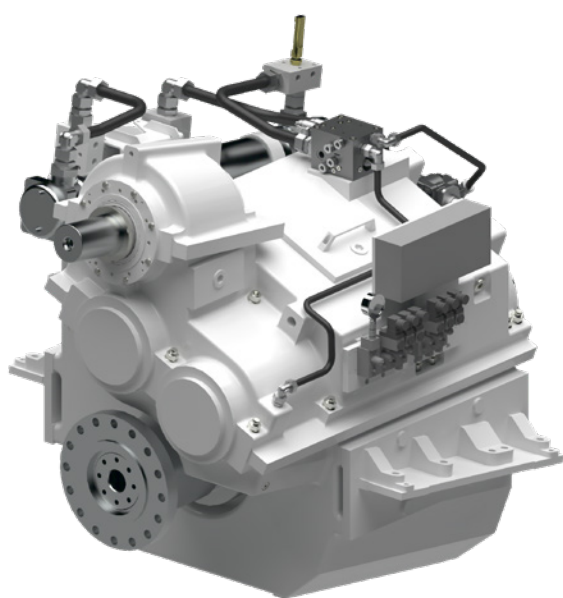
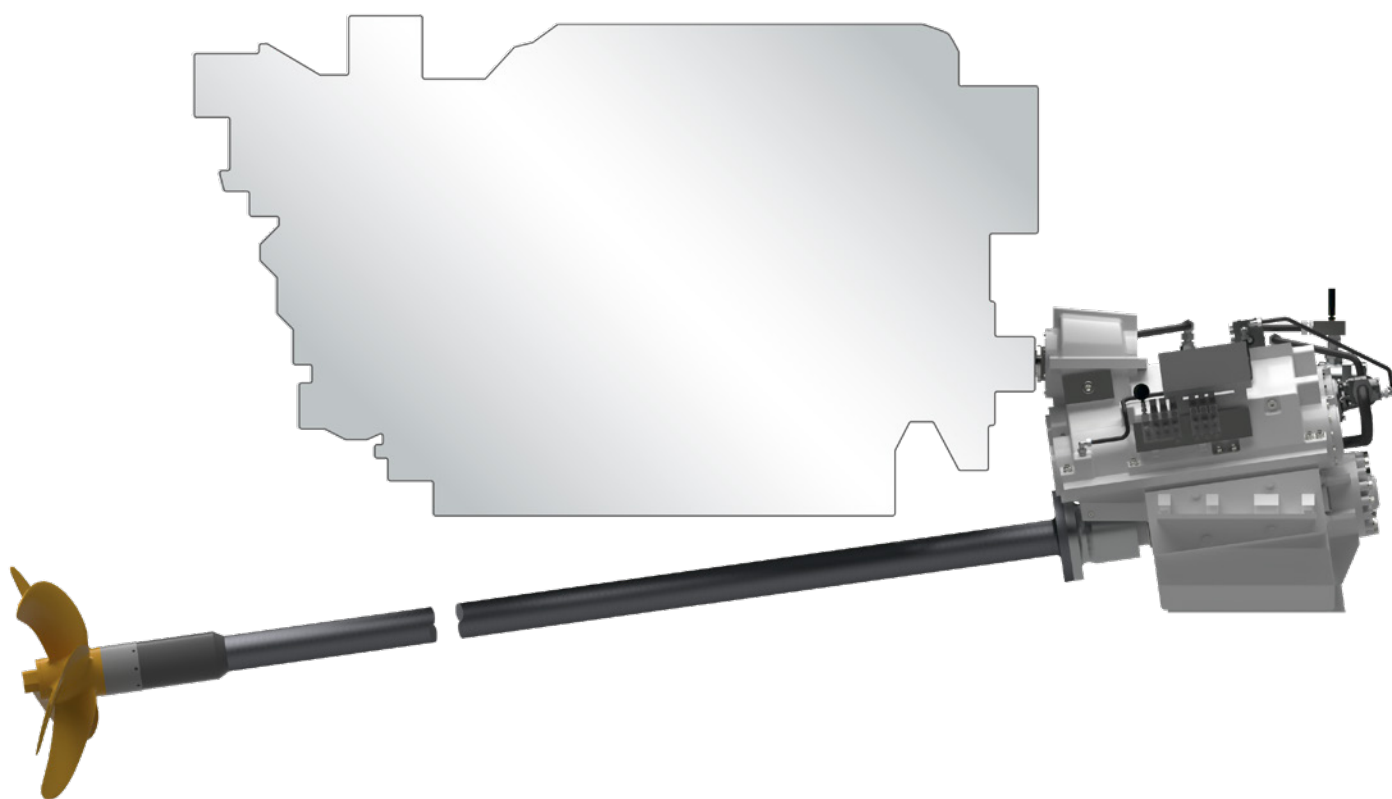

WWSFA 1542 U, engine and propeller side

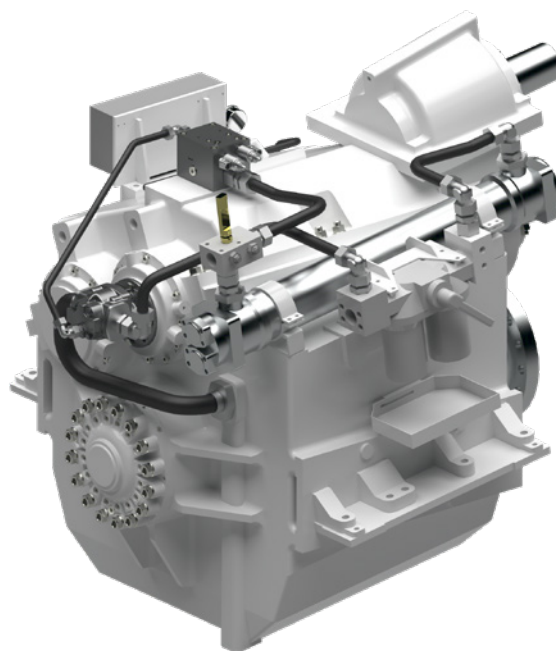

WWSFA 1542 U, opposite side



This document and any data contained herein are subject to modifications or updates at any time and are always non-binding. The data serve informational purposes and cannot be guaranteed in any way. In addition, any data and information will be assessed and determined individually for each project and purpose. This is necessary due to differing characteristics of each project. If this document is delivered in another language than English and in case of divergences of interpretation between the different language texts, the English text shall prevail. Pictures and logos courtesy from all owners of the respective trademarks and rights. Gearbox standard design is dry. All lists only show an extract of gearboxes available. Additional sizes, offset configurations and variations are available on request.

Dimensions and dry weights are approximate and may vary with housing or by input and ratio. Specifications are subject to change without notice. Please contact your REINTJES distributor for current information and binding data.

REINTJES GmbH
Eugen-Reintjes-Straße 7
31785 Hameln
Germany

E-Mail: info@reintjes-gears.de
Phone: +49 5151 1040

www.reintjes-gears.com

Scan here to
download all our
product brochures

